



MATHS

BOOKS - SUBHASH PUBLICATION

MENSURATION

Exercise

1. Find the Perimeter of each of the following figures:

(a)

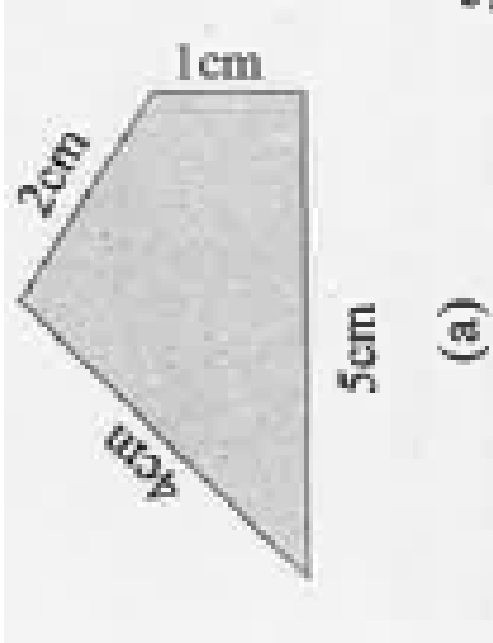

 [Watch Video Solution](#)

2. Find the Perimeter of each of the following figures:

(b)

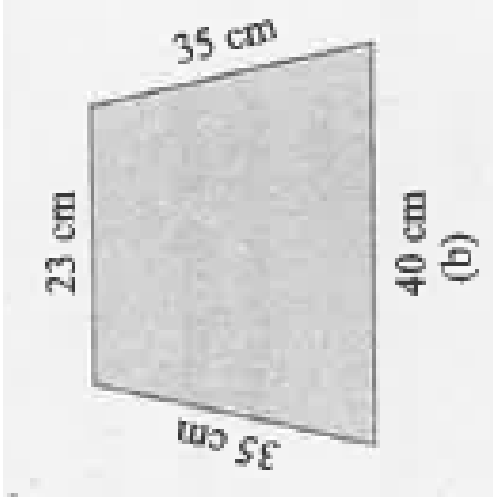

Watch Video Solution

3. Find the Perimeter of each of the following figures: (

c)

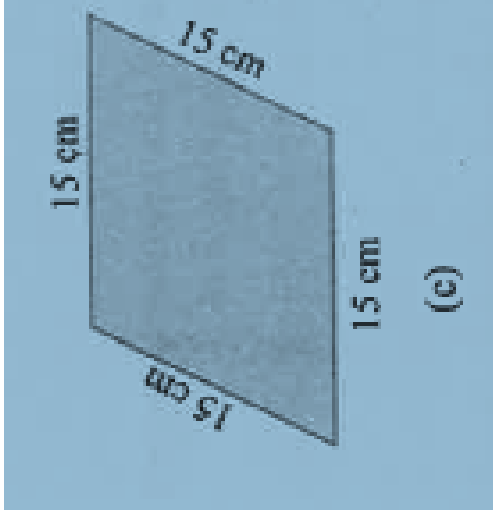

Watch Video Solution

4. Find the Perimeter of each of the following figures:

(d)

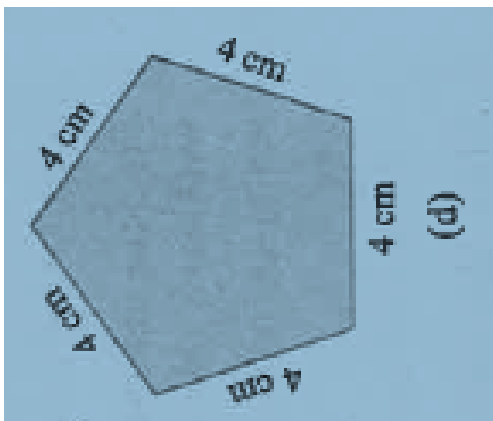



[Watch Video Solution](#)

5. Find the Perimeter of each of the following figures:

(e)



Regular Closed Figures Figures having all the sides of equal length and all the angles of equal measure are known as regular closed figures. Therefore a square and an equilateral triangle are regular closed figures. Problem: Find the perimeter of each of ...



[Watch Video Solution](#)

6. The lid of a rectangular box of sides 40 cm by 10 cm is sealed all round with tape. What is the length of the tape required?



[Watch Video Solution](#)

7. A table-top measures 2 m 25 cm by 1 m 50 cm. What is the perimeter of the table-top?



[Watch Video Solution](#)

8. What is the length of the wooden stirp required to frame a photograph of length and breadth 32 cm and

21 cm respectively?



[Watch Video Solution](#)

9. A rectangular piece of land measures 0.7 km by 0.5 km. Each side is to be fenced with 4 rows of wires. What is the length of the wire needed?



[Watch Video Solution](#)

10. Find the perimeter of each of the following shapes:
(a) A triangle of sides 3 cm, 4 cm and 5 cm.



[Watch Video Solution](#)

11. Find the perimeter of each of the following shapes:

(b) An equilateral triangle of side 9 cm.



Watch Video Solution

12. Find the perimeter of each of the following shapes:

(c) An isosceles triangle with equal sides 8 cm each and third side 6 cm.



Watch Video Solution

13. Find the perimeter of a triangle with sides measuring 10 cm, 14 cm and 15 cm.



[Watch Video Solution](#)

14. Find the perimeter of a regular hexagon with each side measuring 8 m.



[Watch Video Solution](#)

15. Find the side of the square whose perimeter is 20m.



[Watch Video Solution](#)

16. The perimeter of a regular pentagon is 100 cm.

How long is its each side?



Watch Video Solution

17. A piece of string is 30 cm long. What will be the length of each side if the string is used to form: (a) a square?



Watch Video Solution

18. A piece of string is 30 cm long. What will be the length of each side if the string is used to form: (b) an

equilateral triangle?



[Watch Video Solution](#)

19. A piece of string is 30 cm long. What will be the length of each side if the string is used to form: (c) a regular hexagon?



[Watch Video Solution](#)

20. Two sides of a triangle are 12 cm and 14 cm. The perimeter of the triangle is 36 cm. What is its third side?



[Watch Video Solution](#)

21. Find the cost of fencing a square park of side 250 m at the rate of ₹ 20 per metre.

 [Watch Video Solution](#)

22. Find the cost of fencing a rectangular park of length 175 m and breadth 125 m at the rate of ₹ 12 per metre.

 [Watch Video Solution](#)

23. Sweety runs around a square park of side 75m. Bulbul runs around a rectangular park with length 60 m and breadth 45. Who covers less distance?

 [Watch Video Solution](#)

24. What is the perimeter of each of the following figures? What do you infer from the answers? (a)



q16-what-is-the-perimeter-of-e | LIDO

 [Watch Video Solution](#)

25. What is the perimeter of each of the following figures? What do you infer from the answers? (b)

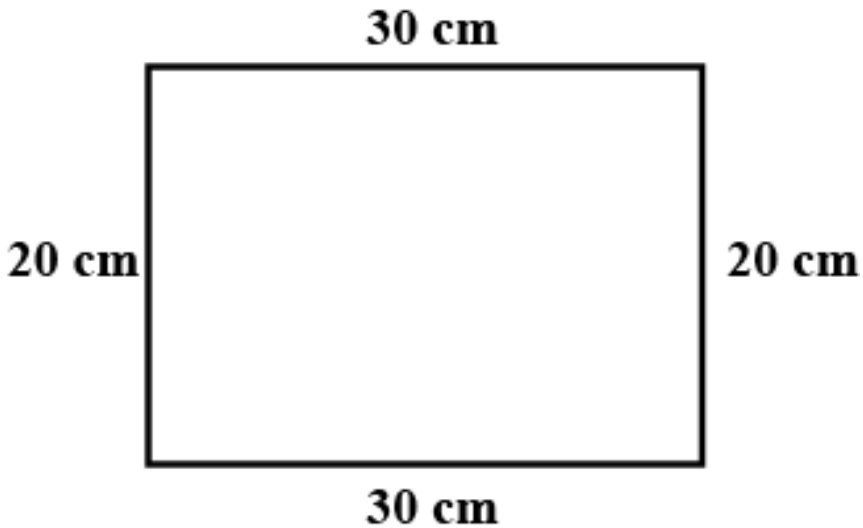

 [Watch Video Solution](#)

26. What is the perimeter of each of the following figures? What do you infer from the answers? (c)



10 cm

40 cm



[Watch Video Solution](#)

27. What is the perimeter of each of the following figures? What do you infer from the answers? (d)



q16-what-is-the-perimeter-of-e | LIDO



[Watch Video Solution](#)

28. Avneet buys 9 square paving slabs, each with a side of $\frac{1}{2}$ m. He lays them in the form of a square.



(a) What is the perimeter of his arrangement [Fig 10.7(i)]?

 [Watch Video Solution](#)

29. Avneet buys 9 square paving slabs, each with a side of $1/2$ m. He lays them in the form of a square.

(b) Shari does not like his arrangement. She gets him to lay them out like a cross. What is the perimeter of her arrangement [(Fig 10.7(ii))]

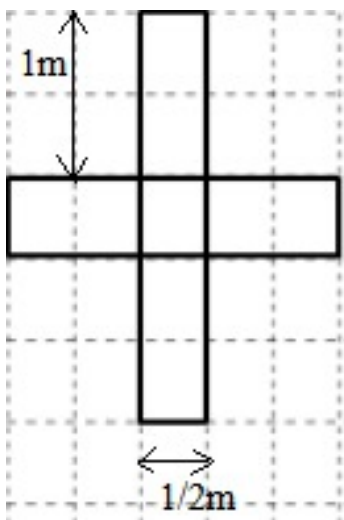

[Watch Video Solution](#)

30. Avneet buys 9 square paving slabs, each with a side of $\frac{1}{2}$ m. He lays them in the form of a square.

(c) Which has greater perimeter?

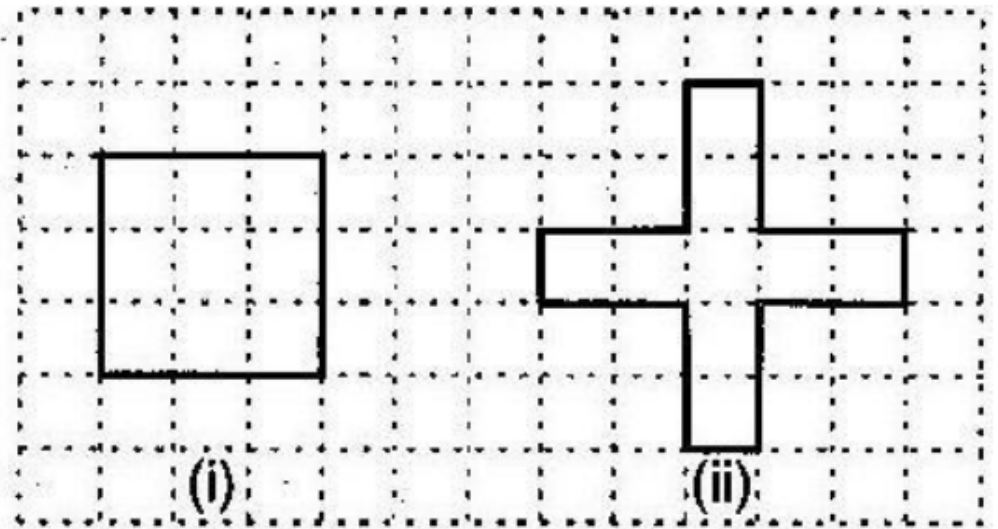

Watch Video Solution

31. Avneet buys 9 square paving slabs, each with a side of $\frac{1}{2}$ m. He lays them in the form of a square.

(d) Avneet wonders if there is a way of getting an even greater perimeter. Can you find a way of doing this?

(The paving slabs must meet along complete edges i.e. they cannot be broken.)

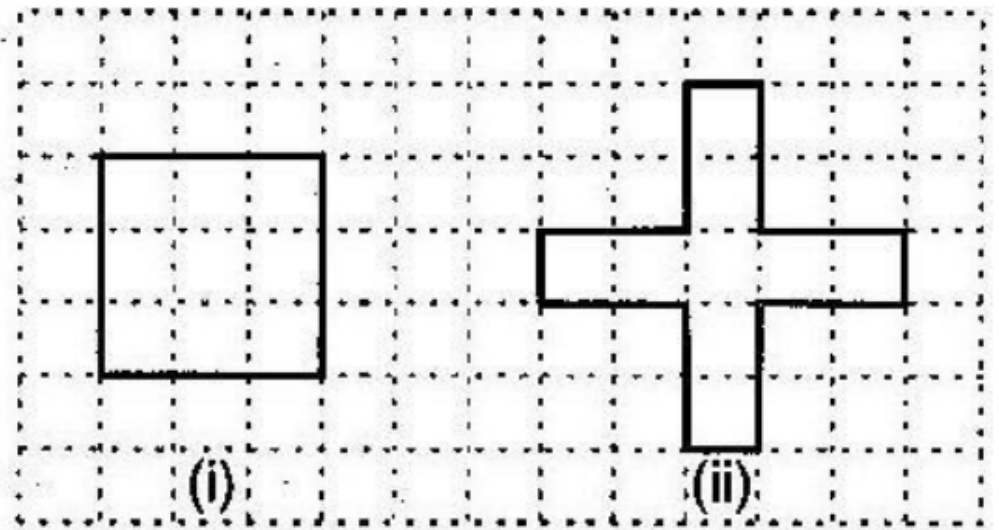

Watch Video Solution

32. Find the areas of the following figures by counting square:

(a),(b),(c), (d), (e), (f), (g), (h), (i), (j), (k), (l),(m),(n)

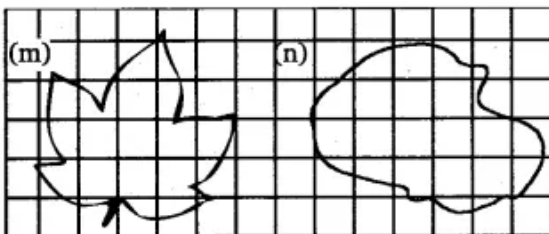
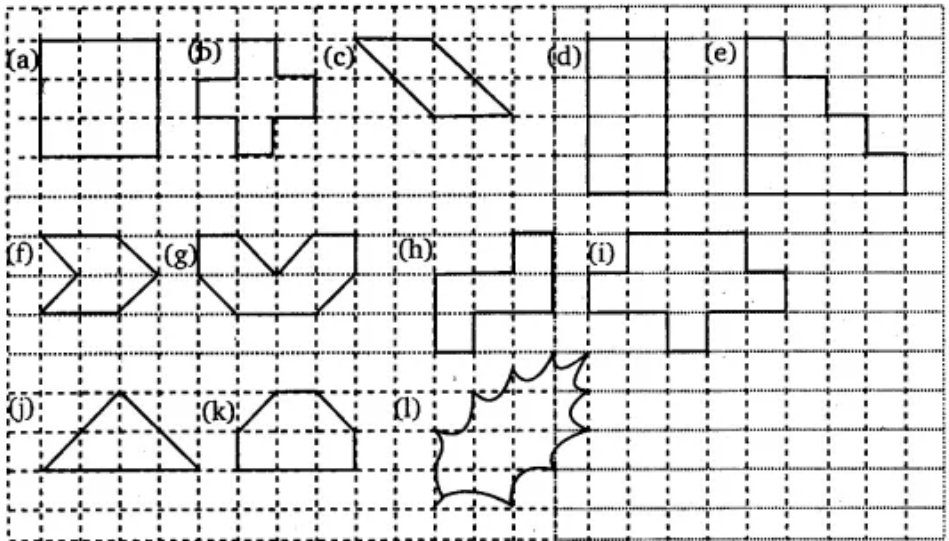



[Watch Video Solution](#)

33. Find the areas of the rectangles whose sides are :

(a) 3 cm and 4 cm



[Watch Video Solution](#)

34. Find the areas of the rectangles whose sides are :

(b) 12m and 21 m



[Watch Video Solution](#)

35. Find the areas of the rectangles whose sides are : (

c) 2 km and 3km

 [Watch Video Solution](#)

36. Find the areas of the rectangles whose sides are :

(d) 2m and 70 cm

 [Watch Video Solution](#)

37. Find the areas of the squares whose sides are : (a)

10 cm

 [Watch Video Solution](#)

38. Find the areas of the squares whose sides are : (b)

14 cm



Watch Video Solution

39. Find the areas of the squares whose sides are : (c)

5 cm



Watch Video Solution

40. The length and breadth of rectangle is as given below : (a) 9m and 6 m Find the area.



[Watch Video Solution](#)

41. The length and breadth of rectangle is as given below : (b) 17m and 3 m Find the area.



[Watch Video Solution](#)

42. The length and breadth of three rectangles are as given below : (c) 4m and 14 m Which one has largest area and which one has the smallest ?



[Watch Video Solution](#)

43. The area of a rectangular garden 50 m long is 300 sq m. Find the width of the garden.



Watch Video Solution

44. What is the cost of tilling a rectangular plot of land 500 m long and 200 m wide at the rate of ₹ 8 per hundred sq m. ?



Watch Video Solution

45. A table-top measures 2 m by 1 m 50 cm. What is its area in square metres ?



[Watch Video Solution](#)

46. A room is 4 m long and 3 m 50 cm wide. How many square metres of carpet is needed to cover the floor of the room?



[Watch Video Solution](#)

47. A floor is 5 m long and 4 m wide. A square carpet of sides 3 m is laid on the floor. Find the area of the floor that is not carpeted.



[Watch Video Solution](#)

48. Five square flower beds each of sides 1 m are dug on a piece of land 5 m long and 4 m wide. What is the area of the remaining part of the land?



Watch Video Solution

49. By splitting the following figures into rectangles, find their areas (The measures are given in

centimetres).

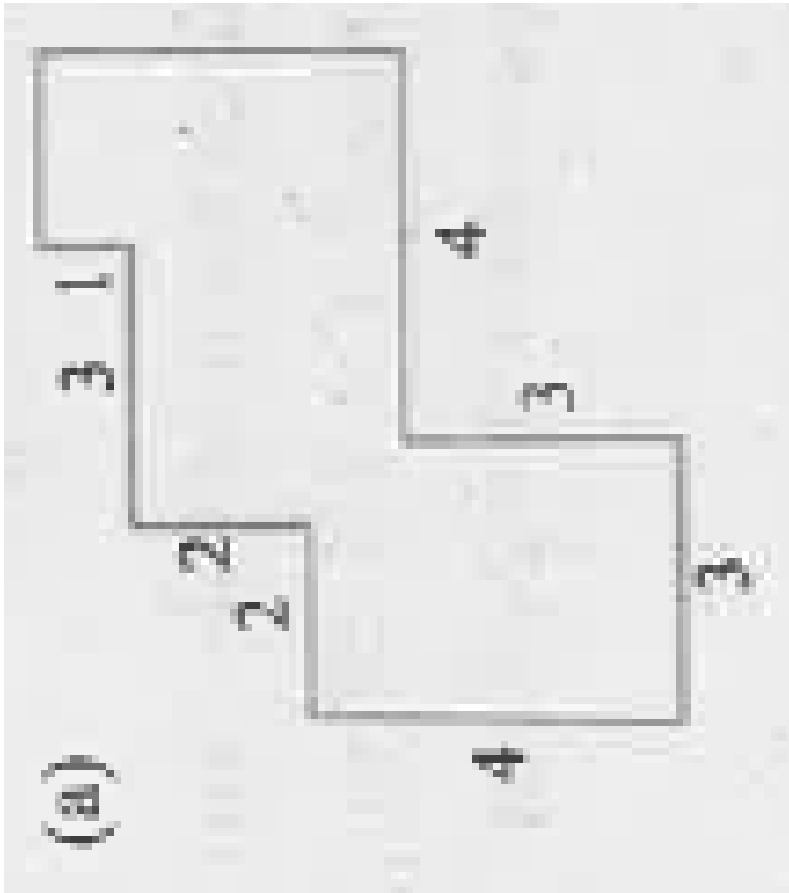

(a)



[Watch Video Solution](#)

50. By splitting the following figures into rectangles, find their areas (The measures are given in centimetres).

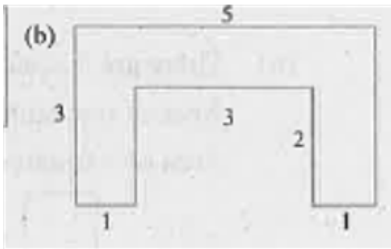

[Watch Video Solution](#)

51. Split the following shapes into rectangles and find their areas. (The measures are given in centimetres)

(a)

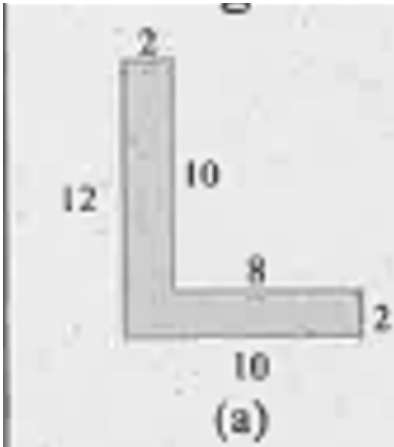

 [Watch Video Solution](#)

52. Split the following shapes into rectangles and find their areas. (The measures are given in centimetres)

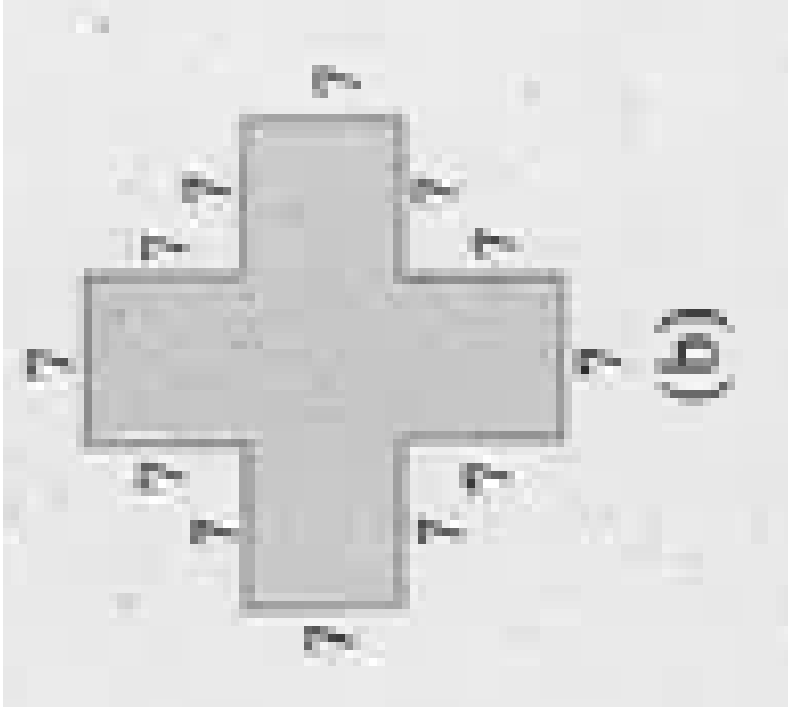

[▶ Watch Video Solution](#)

53. Split the following shapes into rectangles and find their areas. (The measures are given in centimetres) (c

)

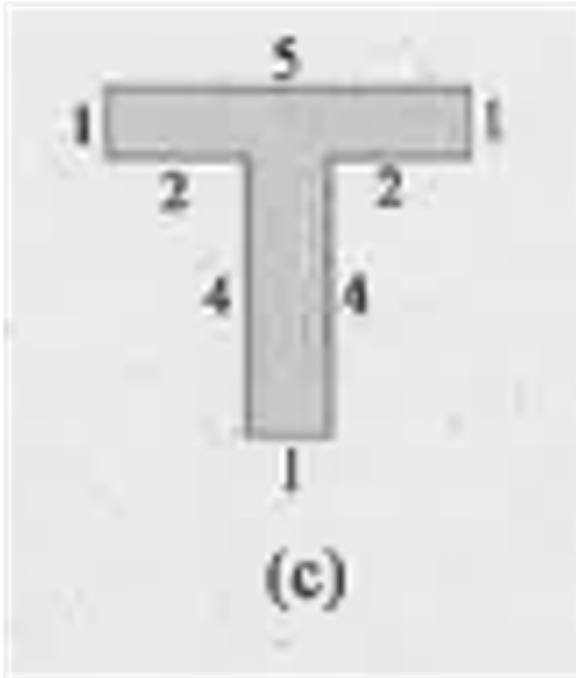

Watch Video Solution

54. How many tiles whose length and breadth are 12 cm and 5 cm respectively will be needed to fit in a

rectangular region whose length and breadth are respectively: (a) 100 cm and 144 cm



[Watch Video Solution](#)

55. How many tiles whose length and breadth are 12 cm and 5 cm respectively will be needed to fit in a rectangular region whose length and breadth are respectively: (b) 70 cm and 36 cm.



[Watch Video Solution](#)